

# Set up and use your HP ENVY Inspire printer with a Chromebook

The fastest way to set up your HP ENVY Inspire printer is through the HP Smart app on a mobile device (Android or iOS). Alternatively, you can also connect your printer to the network through the printer control panel to complete setup.

You can download HP Smart from [123.hp.com](https://123.hp.com) or your app store.

## 1. Connect your printer to the network from the printer control panel

If you are unable to connect your printer using HP Smart, you can also connect your printer from the printer control panel.



**NOTE:** Before you begin, check the following:

- The Wi-Fi network is set up and working properly.
- The Chromebook is connected to the network.
- The printer is close enough to the router to ensure a strong Wi-Fi signal.

1. From the **Get HP Smart Software** screen, touch the Help icon **?**.

If the control panel is at the home screen, skip to step 6.



2. Touch **Connect Later**.

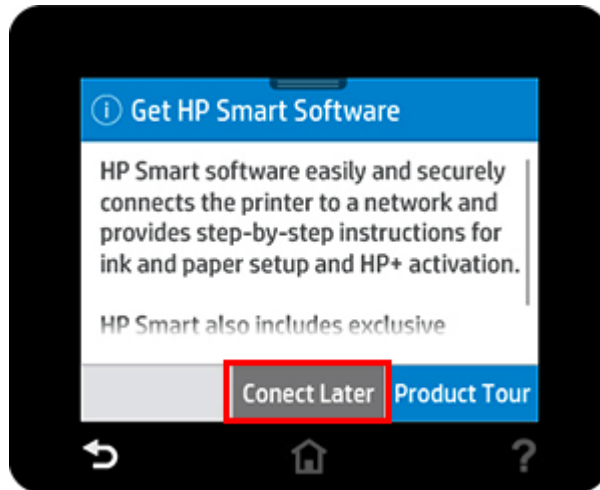

3. Touch **OK**.
4. Select **Auto Update (Recommended)**, and then touch **Save**.
5. Touch **Continue** to align the printhead.
6. From the printer Home screen, touch or swipe down the tab at the top of the screen to open the Dashboard.

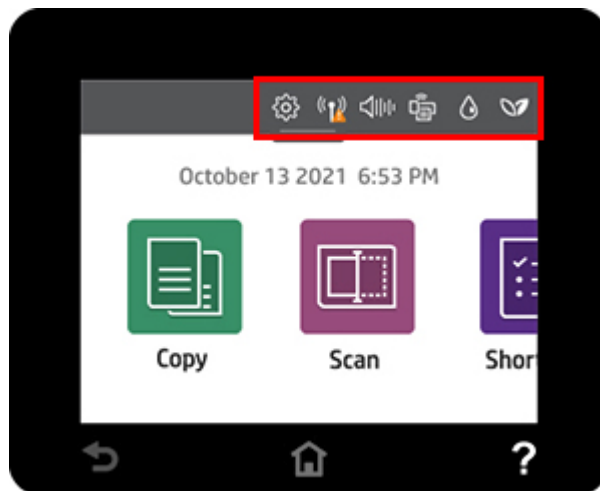

7. Touch the Wi-Fi icon (📶).
8. Touch the Settings icon (⚙️).
9. Touch **Wireless Setup Wizard**.
10. Follow the steps in the **Wireless Setup Wizard** to connect your printer to the network.

## 2. Set up your Chromebook for printing

You can print photos, documents, webpages, and email through the Chrome browser and supported apps.



**NOTE:** Ensure that the printer is connected to the network before you start printing.

## Add your printer to the Chromebook

If you have not added your printer to the Chromebook, complete the following steps:

1. On the Chromebook, click the clock in the bottom right corner, and then click the Settings icon .
2. Scroll to the bottom of the screen, and then click **Advanced**.
3. Under **Printing**, click **Printers**, and then click **Add Printer**.
  - Printer listed: Select the printer and select **Add**.
  - Printer not listed: Select **Add manually** and follow the on-screen instructions to add the printer.



For more information, go to [Chromebook Help -Set up your printer](#).

## Print from your Chromebook

1. Open the file you want to print.

2. In the Chrome browser, click the Settings icon, and then select **Print**.

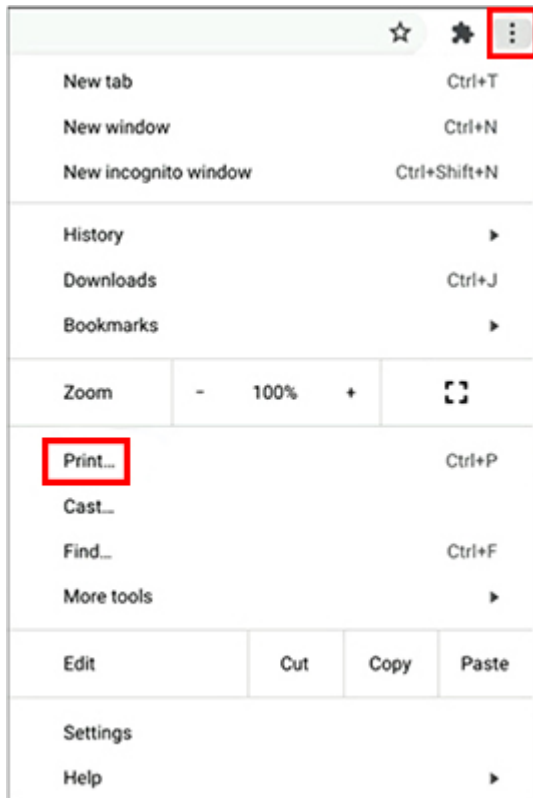

3. Next to **Destination**, click **Change**, and then select your printer.

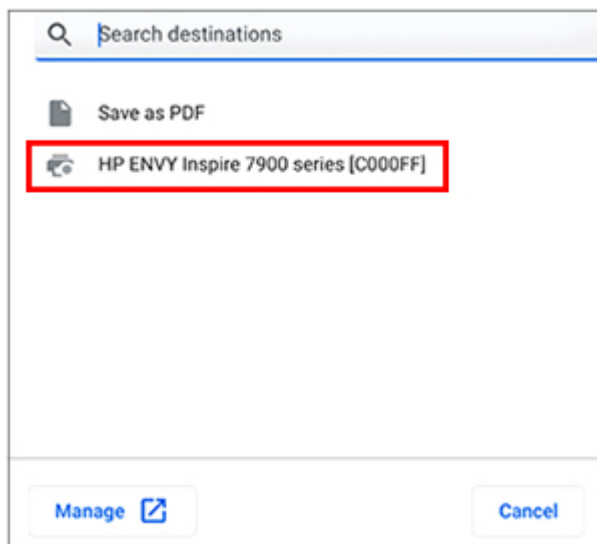

4. Change any desired print settings, and then click **Print**.